

| 版本 Rev. | 日期 Date | 变更文件号 ECN NO. | 变更内容 Revisions | 设计 By |
|---------|----------|---------------|----------------|-------|
| V1.0 | 17.05.18 | | 新外观 | 王洪松 |
| | 17.09.13 | | | Max |

Dimension: (Unit: mm)

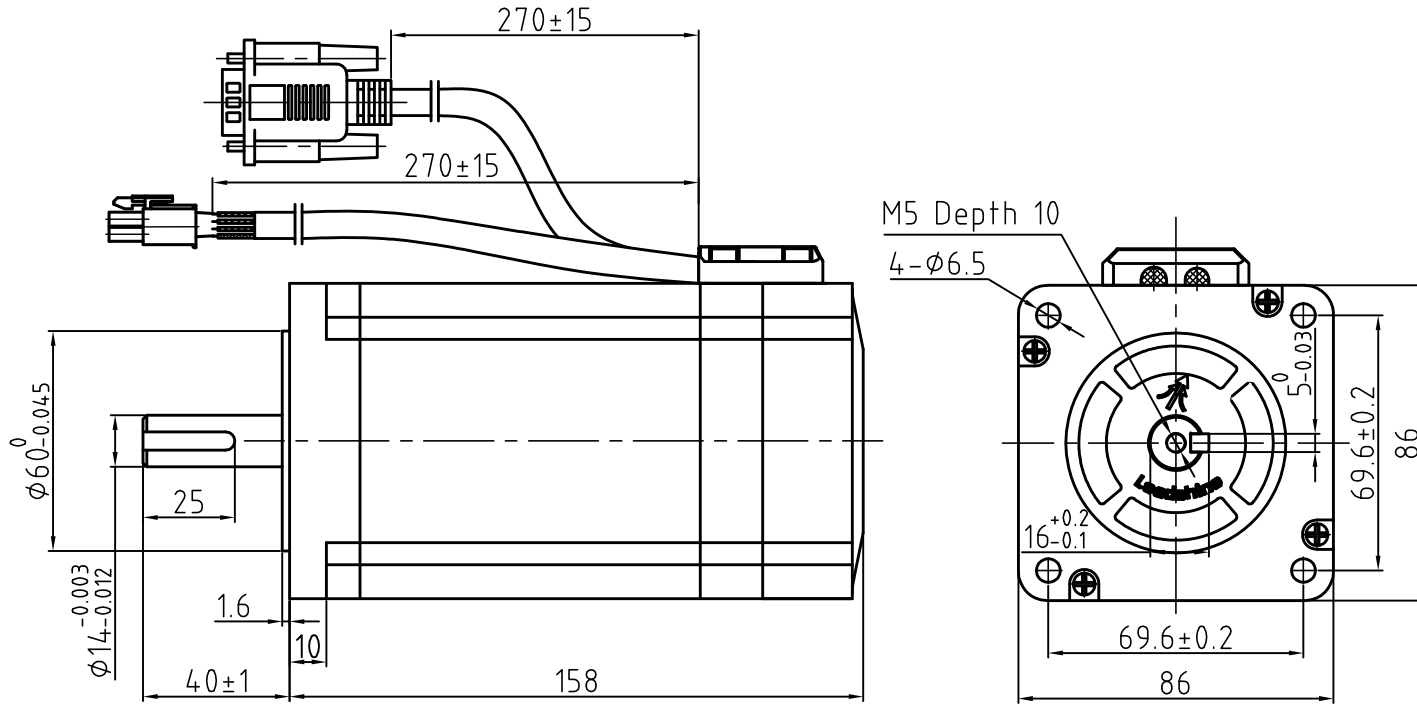

Motor Connctions

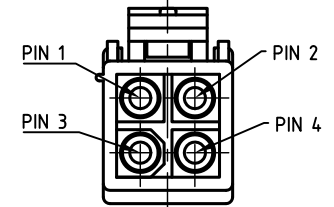

A+ 黑 Black

A- 红 Red

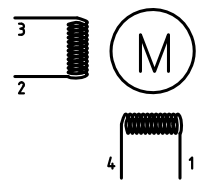

B+ 黄 Yellow B- 蓝 Blue

Encoder Signals

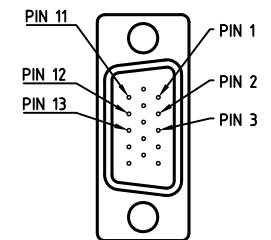

| PIN | 1 | 2 | 3 | 11 | 12 | 13 |
|--------|-----|-----|-----|-----|-----|-----|
| Color | BLK | RED | WHT | YEL | GRN | BLU |
| Define | A+ | VCC | GND | B+ | B- | A- |

Common Rating

| | |
|-----------------------|-----------------------|
| Step angle | 1.8° |
| Position accuracy | 1.8±0.09° |
| Dielectric strength | 1000VAC 1min |
| Insulation resistance | 100MΩhm(500VDC) |
| Insulation class | F |
| Temp rise(Max) | 80K |
| Radial play | Max.0.02mm(Load 450g) |
| Axial play | Max.0.08mm(Load 900g) |

Specification

| | |
|--------------------------|-------------|
| Current/phase | 6.0 A |
| Voltage | 4.5 V |
| DC Resistance/phase ±10% | 0.75 Ω |
| Inductance/phase ±20% | 5.3 mH |
| Holding torque | 12 N·M |
| Inertia | 2.94 kg·cm² |
| Weight | 4.7 kg |
| Encoder Resolution | 1000 cpr |

| | | | | | | |
|----------------|-----|------------|------------|---------------------------------|--|--------------------|
| 设计 Designed | 王洪松 | 日期 Date | 2017.05.18 | 材料 Material | 深圳市雷赛智能控制股份有限公司 SHENZHEN LEADSHINE TECHNOLOGY CO., LTD. | |
| 审核 Checked | 刘佩峰 | 2017.05.18 | | 第一角画法 First Angle projection | 名称 Title | |
| 批准 Approved | 田天胜 | 2017.05.18 | | 重量 Weight | 比例 Scale | 阶段标记 Stage Mark |
| 料号 Part No. | | | | 共 1 页 第 1 页 Sheet 1 of 1 | | 图号 DWG. NO. |
| | | | | | CS-M234120 | |
| | | | | | LS-CME86-05-0010-02 | |